

TILLAMOOK COUNTY SURVEYORS OFFICE

Initial Point Pacific Dunes Unit No.3
In Section 29 T.3N.,R.10W.,W.M



I set a 3" Tillamook County Surveyors brass cap on a 1 1/2" iron pipe in 10" concrete cylinder at the position of a found 2" iron pipe with plug and nail.

History of Found Monument

The found 2" iron pipe was the original monument set for this subdivision on Tillamook County Surveyors map #C-426. I laid the found 2" iron pipe alongside of the concrete monument.

Location of Monument

This monument is located approximately 5 feet east of the toe of a sand dune.

In the presence of Dan McNutt & Al Dvorak

January 1990

Title:

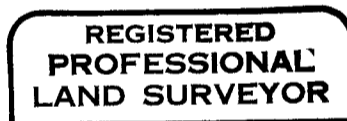

Allan E. Duncan, C.S.

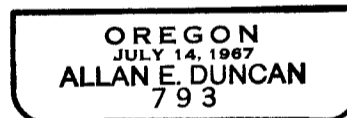

BOOK 6 447